

# FABROCK® CWP

## Curtain Wall Insulation



### ROCKWOOL stone wool insulation:

- Rated Euroclass A1 – will not develop toxic smoke or promote flame spread in the event of fire
- Dimensionally stable – maintains thermal performance for lifetime of installation
- Acoustically absorbent – traps sound waves to reduce external noise transfer

ROCKWOOL FABROCK® CWP simultaneously addresses fire resistance, thermal and acoustic performance requirements for a variety of curtain wall systems.

This comprehensive turn-key solution comprises three A1 rated non-combustible products: FABROCK® CWP 410 Core, FABROCK® CWP 411 Edge and FABROCK® Therm 413.

Readily available in a wide range of close tolerance thicknesses, ROCKWOOL FABROCK® CWP is manufactured to bespoke specifications, providing an efficient and proven specification for offsite construction.

Email us to learn more about the comprehensive packages available for specifiers and panel manufacturers:

[CoreSolutionsMarketing@rockwool.com](mailto:CoreSolutionsMarketing@rockwool.com)

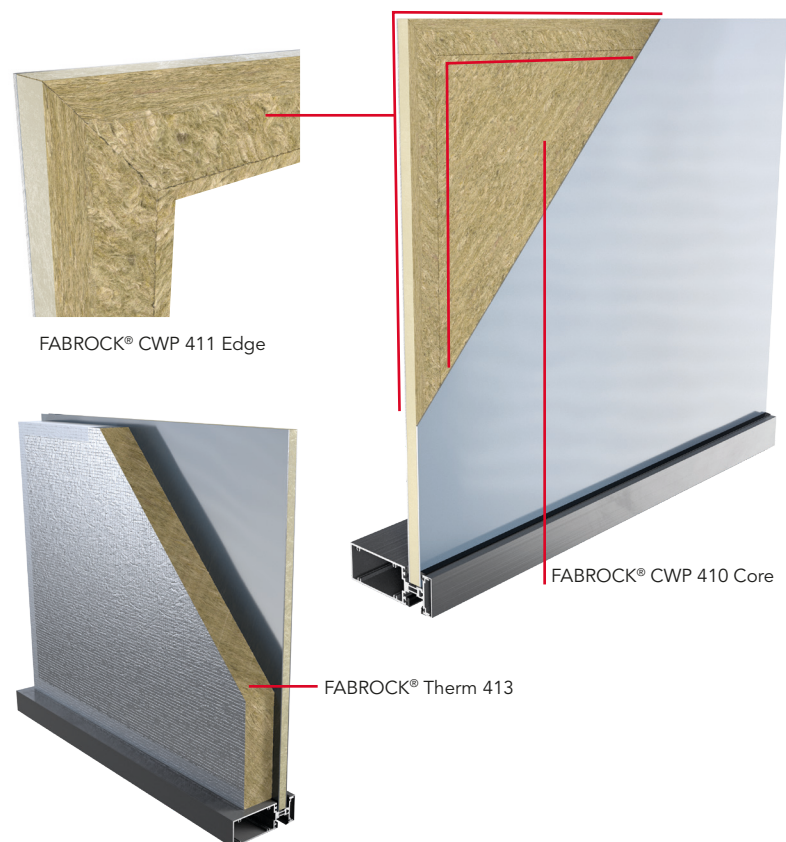

ROCKWOOL FABROCK® CWP is a range of three products designed for fire rated curtain wall applications.

Product name	FABROCK® CWP 410 Core	FABROCK® CWP 411 Edge	FABROCK® Therm 413	Unit	Test standard
<b>Fire performance</b>					
Reaction to fire - Euroclass	A1	A1	A1	-	EN 13501-1
<b>Thermal performance</b>					
Thermal conductivity (board)	38	39	36	mW/mK	EN 12667
Thermal conductivity (lamella)	-	52	-	mW/mK	EN 12667
<b>Mechanical performance</b>					
Compression strength (cs) (board)	30	65	15	kPa	EN 826
Compression e-modulus (board , *lamella)	0.5	30*	-	mPa	EN 826
Compression strength (cs) (lamella)	-	150	-	kPa	EN 826
Tensile strength perpendicular to face (board)	13	17	5	kPa	EN 1607
Tensile strength perpendicular to face (lamella)	-	150	-	kPa	EN 1607
<b>Water repellent performance</b>					
Water absorption (short-term)	<1	<1	<1	kg/m <sup>2</sup>	EN 1609
Water absorption (long-term)	<3	<3	<3	kg/m <sup>2</sup>	EN 12087
<b>Specialised information</b>					
Thickness range	On request	On request	-	-	-
Dimensions	On request	On request	-	-	-
Facings	Two sided grinded	One side glass tissue	One side aluminium foil / One side grinded	-	-
Optimised surface for gluing	Yes	-	Yes	-	-
<b>Certification</b>					
Health & safety	EUCEB	EUCEB	EUCEB	-	-

For reaction to fire, thermal, acoustic and mechanical performances of the finished composite panel please consult with the panel manufacturer.

*NOTE: Information is up-to-date and correct as at the date of issue. As we cannot control or anticipate the conditions under which our products may be used, each user should review the information in specific context of the planned use. It is the user's responsibility to validate that our products with the properties described in the specification is suitable for use in its application. No express or implied warranties are given other than those implies mandatory by law. This document is the property of ROCKWOOL International A/S, no alteration or modification is allowed without prior written authorization, no liability shall rise from non-authorized alteration.*

**ROCKWOOL Core Solutions**

CoreSolutionsMarketing@rockwool.com

+33 (0)1 40 77 82 82

www.rockwool.com/group